



**School of Graduate Studies Biomedical Health Sciences
at
New Brunswick/Piscataway Campus
Welcomes You
To the**

**Fall 2019 New Student Orientation
August 15
East Lecture Hall**

RUTGERS

THE STATE UNIVERSITY
OF NEW JERSEY

Program Leadership:

Directors of the Master of Biomedical Science Program

Debabrata Banerjee, PhD, Smita Thakker-Varia, PhD
Joe Kramer, PhD



Congratulations!

**We are proud to announce that 8 of our recent MBS graduates
have been ACCEPTED at
Robert Wood Johnson Medical School**



87 proud MBS alumni attending RWJMS and growing!

History of Rutgers

- 1766 Chartered as Queen's College
- 1825 Named after Colonel Henry Rutgers (Revolutionary War veteran)
- 1864 Appointed NJ's land-grant college
- 1956 Designated a public university
- 1989 Invited to join the Association of American Universities
- 2014 Rutgers joined the Big10
- 2016 Rutgers Celebrated 250 years!



Rutgers has

- 33 Schools and colleges with more than 200 graduate and professional degree programs
- 50,000 undergraduates and 20,000 graduate students from all 50 states and 115 countries

Ranked 24th of 229 top US universities

Center for World University Rankings

Top 10% of American universities in science and engineering research and development expenditures



Rutgers University

Three major Campuses

- **New Brunswick**
- **Newark**
- **Camden**



- 50,857 Undergraduate Students
- 19,919 Graduate Students
- **70,876 total students**
 - Rutgers U–New Brunswick: 50,254 students
 - Rutgers Biomedical and Health Sciences: 6,900 students
 - Rutgers U–Newark: 13,451 students
 - Rutgers U–Camden: 7,171 students

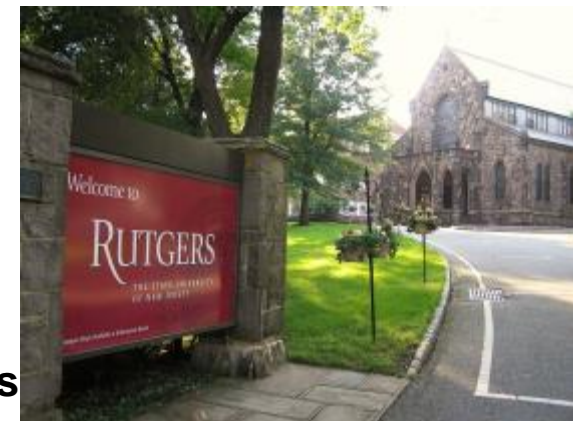

General Outline

- Administration of the program
- Overview of the MBS graduate Program
- University services and policies
- Program expectations
- Next Steps

SGS Biomedical Health Sciences Staff

RWJMS Research Tower R-102



Tina Cicollela
Management Assistant

732-235-2106
cicoletm@rutgers.edu



Johanna Sierra
Admission Coordinator

732-235-5016
sierrajo@rutgers.edu

School of Graduate Studies at New Brunswick/Piscataway
Research Tower R-102

James Millonig, PhD, Senior Associate Dean

Smita Thakker-Varia, PhD, Assistant Dean for Graduate Academic and Student Affairs

Debabrata Banerjee, PhD, Assistant Dean Global Initiatives

<http://rwjms.rutgers.edu/education/gsbs/index.html>

<http://rwjms.rutgers.edu/gsbs/msbs.html>

Your Undergraduate Majors

- American Studies Applied Kinesiology
- **Biology**, Biochemistry, Biomedical Engineering, Bio. Sciences, Biopsychology, Biology and Business Admin
- Cell Biology, Cell Bio Neuroscience, Chemistry, Civil Engineering
- Economics, Engineering, Exercise Science
- Finance and Accounting, Finance
- General Biology, Genetics
- Health Science, Hebrew and Judaic, Human Biology
- Kinesiology
- Life Science
- Mathematics, Microbiology Medicine, Health and Society
- Neuroscience, Nutrition
- Pharmaceutical, Polymer Engineering, Psychology Public Health
- Spanish

Your Undergraduate Colleges or Universities

- Amity University
- Boston College, Boston University
- California St U. East Bay, Case Western Reserve, Chang Gung U., Colby College, Cornell U, College of New Jersey (5), CUNY Brooklyn College (3), CUNY Queen College.
- Duquesne U
- Fairleigh Dickinson U Madison, Fordham University
- Georgia Mason U, Guizhou U
- Indiana University Pennsylvania
- Johns Hopkins U
- Kean University,
- Lafayette College, Lee U, Lehigh U
- Manhattan College, Marquette U, Middle East Technical U, Montclair State U (2), Muhlenberg College
- New York U (2)
- Penn State U (2), Providence College
- **Rutgers U (41)**
- Seton Hall U (3), Spelman College, St Cloud State, Stony Brook U SUNY (4)
- Tamil Univ., Temple U, Texas State U San Marcos, Texas Womans U
- U Calif. Irvine, U Calif. Los Angeles, U Connecticut, U. Maryland College Park (3), U. Mass Lowell, U Maryland, U Penn, U Rochester, U St. Thomas Mn, U Wisconsin Madison, U at Albany-SUNY, U of Miami
- Vanderbilt U, Villanova U,
- Western Washington U.

MSBS/MBS: Program Outline

<http://rwjms.rutgers.edu/education/gsbs/msbio.html>

- **Rigorous curriculum**
- **Taught by Medical School Faculty-personal interaction with RWJMS faculty**
- **Need 30 credits to graduate**
- **24 credits didactic courses**
- **6 credits Capstone course**
- **One elective each semester**
- **Grade Point Average of “3.0” (B)**
- **For MSBS-completion of a lab based research thesis (2-3 years)**

MSBS/MBS at SGS-NB/Pisc Curriculum

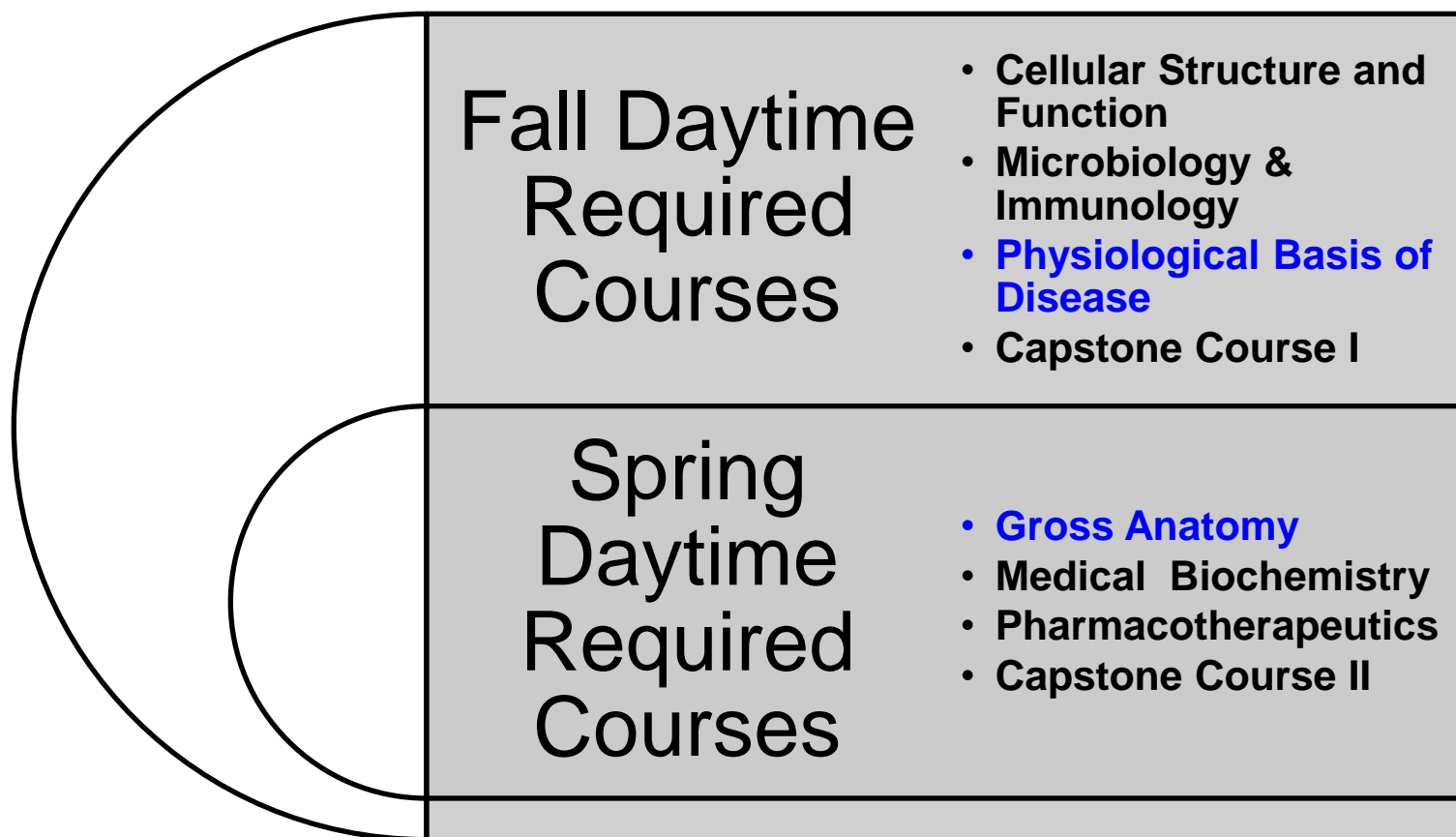

MSBS/MBS at SGS-NB/Pisc Curriculum

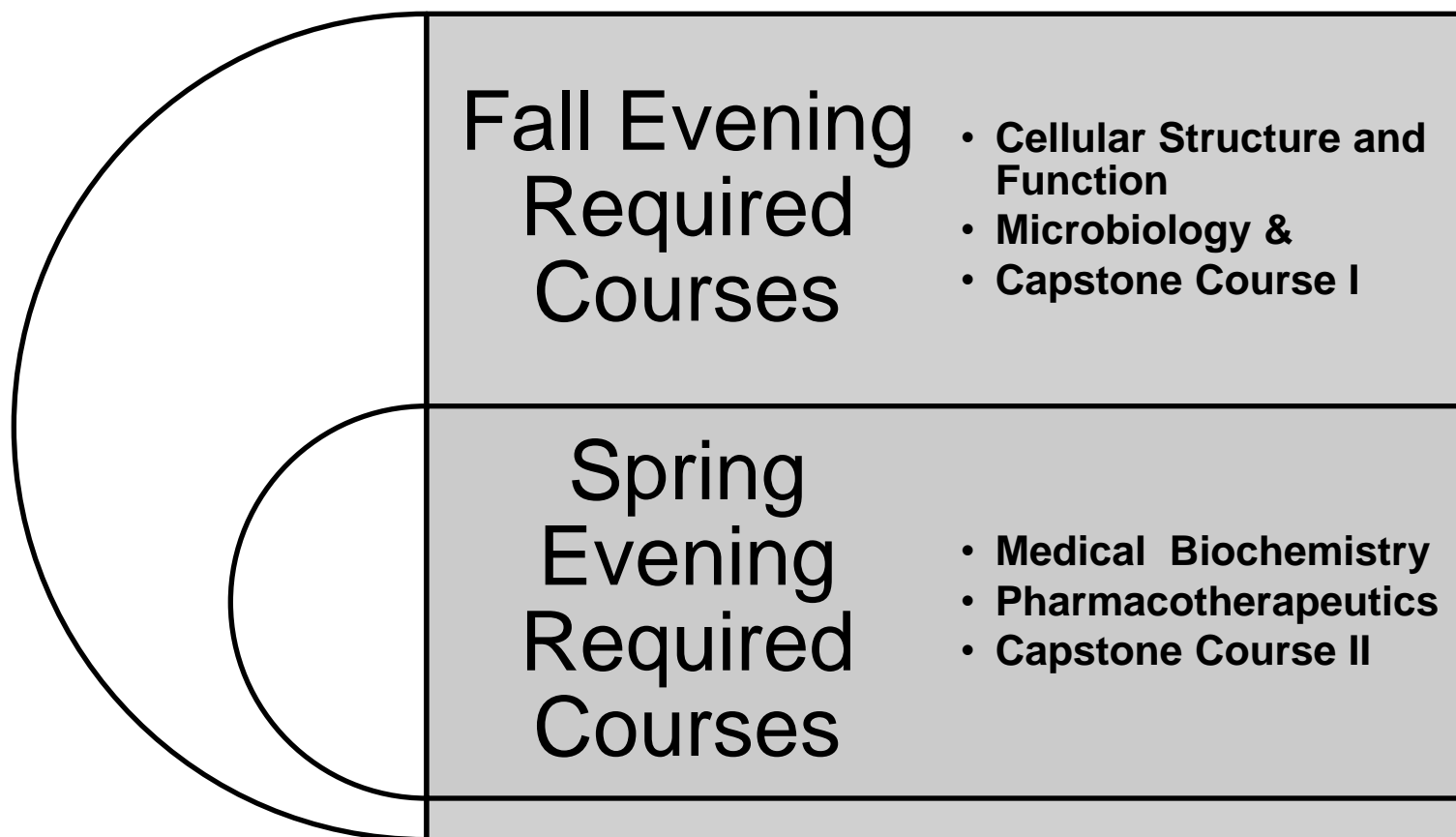

MSBS/MBS at SGS-NB/Pisc Curriculum

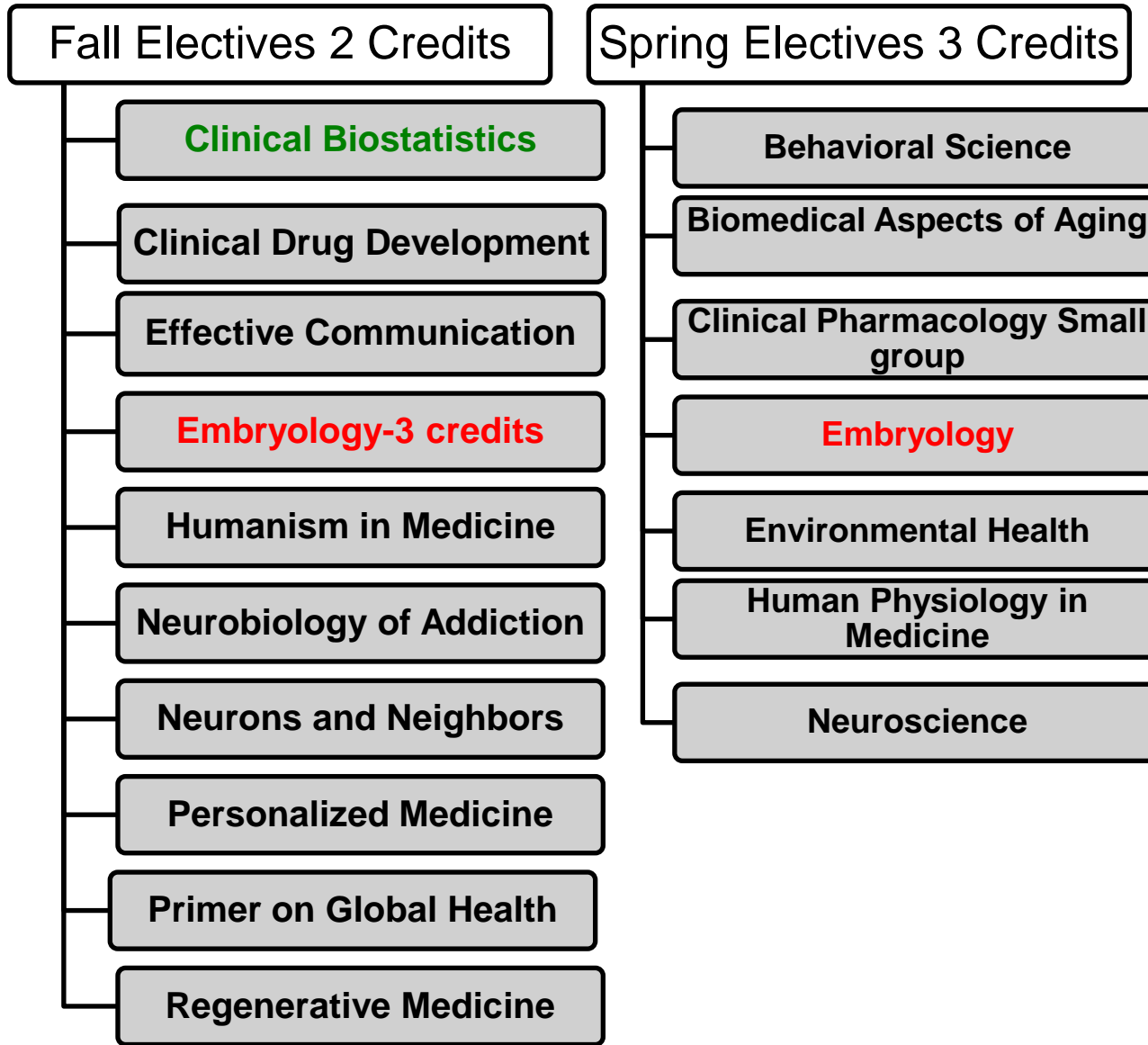

What is the Capstone Course?

- **Required course**
- **Involves an independent mentored project**
- **Defined project with reasonable scope**
- **Mentor helps defining the hypothesis and research methods**
- **Can be literature based or lab based project**
- **Expect to spend at least 9 hours per week or ~100 hours per semester on the project**

**Capstone Course Meeting is on
September XXth at 12:00 PM**

Online Registration begins from August 16 – August 31

- Your bills are due *immediately*. You will be at high risk for *Non-Payment Holds and de-registration* if your balances are not paid immediately following registration.
- Students with completed and approved Financial Aid applications awaiting disbursement of funds will ***not be flagged for non-payment and will not be de-registered*** as they should be identifiable in the system *as Pending Aid* by the Business Office

Register for RUHere Campaign and Financial Responsibility Statement (FRS) for Fall 2019

<https://financialaid.rutgers.edu/ruhere-confirmation-of-attendance-process/>

The RUHere pop-up message will be turned on for SGS starting **August 20, 2019**, students should submit their responses as soon as they have registered but not later than **September 15, 2019**.

Because the entire campaign is designed to confirm students' registration and attendance, students will not see the pop up message until after they have registered for at least one class. The message will start to appear in the CAS login pages the following day after registration has been processed.

Importantly, if you register for classes and do not respond to the RUHere message, your financial aid will not be released if they have aid pending.

Important Logistics

- Health Insurance (waive by **September 30th**)
- Immunization records
- Financial aid
- Rutgers ID Cards (online)
- Pictures to Johanna for our records
- Parking virtual tags (purchase permit on-line)
- Course Registration
- -PINS will be sent to you by email
- Registration is blocked because of lack of payment

Rutgers Connect 365 Email

- Email can be accessed using connect.rutgers.edu and login with your entire email address NetID@gsbs.rutgers.edu and then your NetID password
- RWJ OIT only supports the Rutgers Connect 365 Web Access which can be accessed directly at <https://connect.rutgers.edu>
- RWJ OIT does not support setting up any email clients such as Outlook or MacMail for email and does not support setting up email on any mobile devices
- Rutgers students should submit their old IDs and receive the new ID

Important Information

- Activate your Rutgers email
- Check Rutgers email regularly
- **Check Rutgers email regularly**
- <https://my.rutgers.edu>: the portal
This is the single point of sign-on to many web based resources

- Academic Management Platform (AMP)

all course related materials will be posted

<https://rwjmsamp.rwjms.rutgers.edu/rwjmsed/block/>

MSBS/MBS: Program Outline

<http://rwjms.rutgers.edu/education/gsbms/msbio.html>

Important Links for current MBS Students

Student E-mail

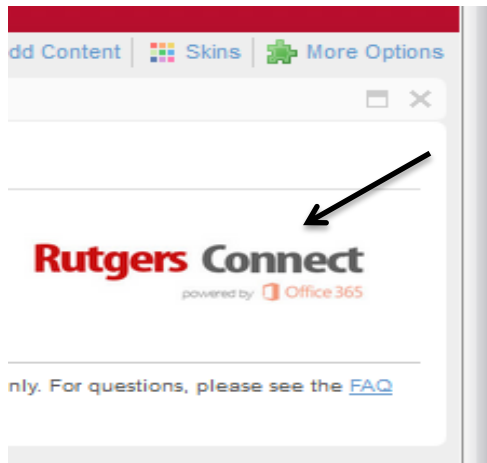

Connect.rutgers.edu

MBS Google Calendar



Academic Management Platform

AMP Portal

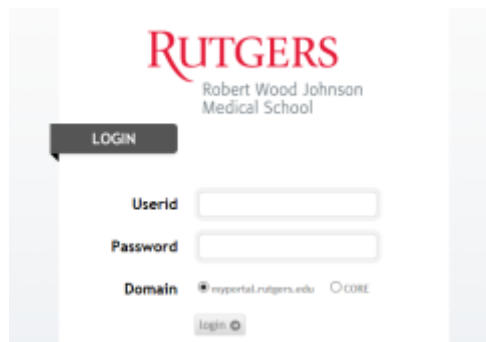

Transportation Services

- 1) **Shuttle service between the Research Tower/CABM (Lot C) in Piscataway to Clinical Academic Building (CAB) in New Brunswick (Monday through Friday, 7:00 AM to 7:00 PM).**
 - rwjms.rutgers.edu/gsbs/student_affairs/Transportation.html
 - Real-time tracking of the shuttle location can be found online by clicking
<http://www.catabus.com/Announcements/Mobileapps.html>
 - or download the mobile app.
- 1) **Campus Bus System**
 - The Rutgers-New Brunswick/Piscataway inter-campus bus and shuttle system is a service provided for all five campuses. Transportation to, from, and on campus includes campus bus, shuttle and public transportation services.
 - <http://gobble.rutgers.edu>

ADD/DROP POLICY

- drop period is defined as **1-10 *academic days** from the beginning of a course
- withdrawal period begins immediately following the drop period and continues through the first **2/3 of the course**.
- Students withdrawing from a course between **11 and 15 academic days** after the course begins will receive an **80% tuition refund**.
- **No tuition** will be refunded beyond **15 academic days** after the course has begun.

COURSE WITHDRAWAL POLICY

- Withdrawals will be noted as “W” on the transcript. Withdrawals will **NOT** be granted during the **final third of a course**.
- withdrawing beyond 10 academic days of the beginning of the course need submission of an “Add/Drop/Withdraw” form. Completed and approved “Add/Drop/Withdraw” forms must be received by the Registrar’s office within the time periods set forth above in order for a course withdrawal to be processed.
- ***An academic day is defined as a day that the Rutgers campus at which the student is enrolled is open for business.**

Your Fees Include

- Student Health Services
- Student & Rec Center
- Campus Bus
- Career Services
- Student Government Association
- iPads

Miscellaneous Items

- **Handbook**
http://rwjms.rutgers.edu/gsbs/current/student_handbook.html
- Academic Forms: all on the website
 - <http://rwjms.rutgers.edu/education/gsbs/current/forms.html>
 - Graduation documents and dates
- Excused absences, approval required (Johanna has forms)
- EXAMSOFT on iPads (will be distributed starting September 4)
- EXAMSOFT Training Session-XX
- Mentoring Program
- Meal Plan??
- Housing end dates??

Some Important Points

- **Gross Anatomy Starts Early in January:** 2 weeks before regular classes begin
- Students will occupy lockers in Fall
- Class attendance IMPORTANT
- Course Evaluations

New This Year: we are working on

- MCAT prep course
- Career panels monthly

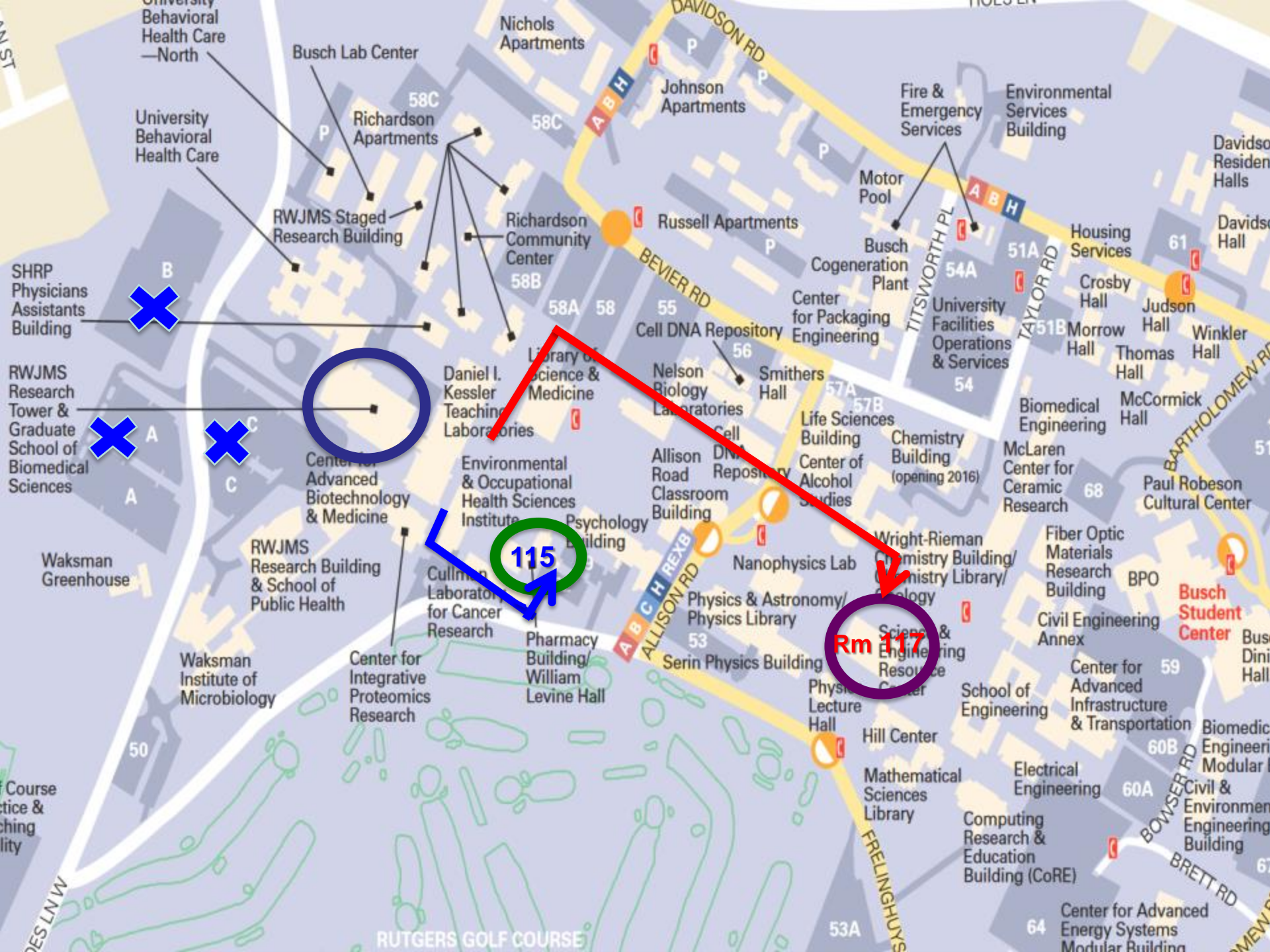

University Behavioral Health Care—North

Busch Lab Center
Richardson Apartments

Nichols Apartments
58C
58B
58A

Johnson Apartments
58C

Fire & Emergency Services
Environmental Services Building

SHRP Physicians Assistants Building

RWJMS Research Tower & Graduate School of Biomedical Sciences

Daniel I. Kessler Teaching Laboratories

Environmental & Occupational Health Sciences Institute

Psychology Building

Pharmacy Building/William Levine Hall

Waksman Institute of Microbiology

RWJMS Research Building & School of Public Health

Center for Advanced Biotechnology & Medicine

Nelson Biology Laboratories

Allison Road Classroom Building

Smithers Hall

Life Sciences Building

Physics & Astronomy/Physics Library

Serin Physics Building

Center for Packaging Engineering

Chemistry Building (opening 2016)

Wright-Rieman Chemistry Building/Chemistry Library/Chemistry

Physics Lecture Hall

McLaren Center for Ceramic Research

Fiber Optic Materials Research Building

Civil Engineering Annex

School of Engineering

Electrical Engineering

Computing Research & Education Building (CoRE)

Biomedical Engineering

Paul Robeson Cultural Center

Center for Advanced Infrastructure & Transportation

Center for Advanced Energy Systems Modular Building

Biomedical Engineering Modular Building

Civil & Environmental Engineering Building

Davidson Residences

Davidson Hall

Winkler Hall

McCormick Hall

Thomas Hall

Morrow Hall

Judson Hall

115

Rm 117

RUTGERS GOLF COURSE

Centers of Excellence at Rutgers RBHS

- Brain Health Institute
- Cancer Institute of New Jersey
- Cardiovascular Institute of New Jersey
- Center for Advanced Biotechnology and Medicine
- Child Development, Institute for the Study of
- Child Health Institute of New Jersey
- Environmental and Occupational Health Science Institute
- Protein Data Base

Graduate School Committee Letter

- **The Program Directors will write the Graduate Committee Letter.**
- **Graduate School reserves the right to refuse committee letters for the students for whom we would recommend with reservations due to poor performance.**

MBS Committee Letter Checklist

ALL OF THESE ITEMS ARE RECOMMENDED IN ORDER FOR US TO WRITE A COMMITTEE LETTER

1. 1 letter of recommendation from MBS faculty or associates
2. 1 letter of recommendation from your capstone mentor
3. Your updated CV
4. AMCAS ID and Letter ID
5. List of faculty writing your letters
6. A detailed autobiographical statement (**written in 3rd person**) with the following items:
 - A brief synopsis of your education and performance thus far including your recent MCAT score
 - A description of your background
 - A description of the journey you have taken to get you to this point
 - Address AAMC Core Competencies
 - Your personal statement (optional but preferred)
 - AMCAS ID and Letter ID

Clinical Shadowing and Volunteering Opportunities

- RWJUH Volunteering Website
<http://www.rwjuh.edu/support/volunteer.html>
- RWJMS Faculty Websites
- Contact area physicians
- The Homeless and Indigent Population Health Outreach Project (HIPHOP) RWJMS
- <http://community.rutgers.edu>

Graduate Student Associations at Rutgers University

- Molecular Biosciences Graduate Student Organization (MBGSO)
 - ***Orientation 2019 Activities:***
 - Game Night: Thursday August 29th, 5:30-8:30, Deans Conf. Room
 - BBQ: Friday August 30th, 1:00 PM, Waksman Courtyard
- NeuroConnections Club (NCC)
- Rutgers Association of Toxicology Students (RATS)
- Biomedical Engineering Student Society (BESS)
- NJ Seeding Labs-collect equipment to help with research in 3rd world countries

Next Year and Other Options

- 1. Anatomy Instructor Certificate Program post MBS**
- 2. Preclinical Pharmacology Track option in MBS interested students (should see the Program Directors)**



DREXEL UNIVERSITY
College of
Medicine



NEW YORK
MEDICAL COLLEGE
A MEMBER OF THE Touro College
AND UNIVERSITY SYSTEM



LOYOLA
UNIVERSITY CHICAGO
STRITCH
SCHOOL of MEDICINE



Kansas City
University
OF MEDICINE
AND BIOSCIENCES



1867
HOWARD
UNIVERSITY



NYU
School of Dentistry



Edward Via College of
Osteopathic Medicine
CAROLINAS CAMPUS

UIC COLLEGE OF
MEDICINE
UNIVERSITY OF ILLINOIS
AT CHICAGO



PENNSTATE HERSHEY
College of Medicine

College of Medicine

EVMS
Eastern Virginia Medical School



ALABAMA COLLEGE
OF OSTEOPATHIC MEDICINE

LSU Health
NEW ORLEANS

MICHIGAN STATE
UNIVERSITY

College of
Osteopathic Medicine

Duke University
School of Medicine

School of Medicine

RUTGERS

New Jersey Medical School



St. George's University
THINK BEYOND
Grenada, West Indies



ROSS UNIVERSITY
SCHOOL OF MEDICINE



LOMA LINDA UNIVERSITY
School of Medicine

LECOM
LAKE ERIE COLLEGE OF OSTEOPATHIC MEDICINE
SCHOOL OF DENTAL MEDICINE



Philadelphia College of
Osteopathic Medicine



ROWAN UNIVERSITY
School of
Osteopathic Medicine

RUTGERS

Robert Wood Johnson
Medical School



TEMPLE
UNIVERSITY
SCHOOL OF DENTISTRY



Tulane
University
SCHOOL OF MEDICINE

UK

UNIVERSITY OF
KENTUCKY
College of Medicine

UAMS
University of Arkansas for Medical Sciences



Cooper Medical School
of Rowan University

TOURO COLLEGE
OF OSTEOPATHIC MEDICINE



UNIVERSITY OF
SOUTH CAROLINA

School of Medicine



THE UNIVERSITY
OF QUEENSLAND
AUSTRALIA



Washington
University in St. Louis
SCHOOL OF MEDICINE



MUSC
MEDICAL UNIVERSITY
of SOUTH CAROLINA

ATSU

ARIZONA SCHOOL
OF DENTISTRY
& ORAL HEALTH



UNIFORMED SERVICES UNIVERSITY
of the Health Sciences

Congratulations!

**We are proud to announce that 8 of our recent MBS graduates
have been ACCEPTED at
Robert Wood Johnson Medical School**



87 proud MBS alumni attending RWJMS and growing!

**We wish you the very BEST
and
remember we are here to help!!**

**Just stay connected with
MBS
Program directors!!!**